

# CentraPower®

## Specification Sheet & Submittal

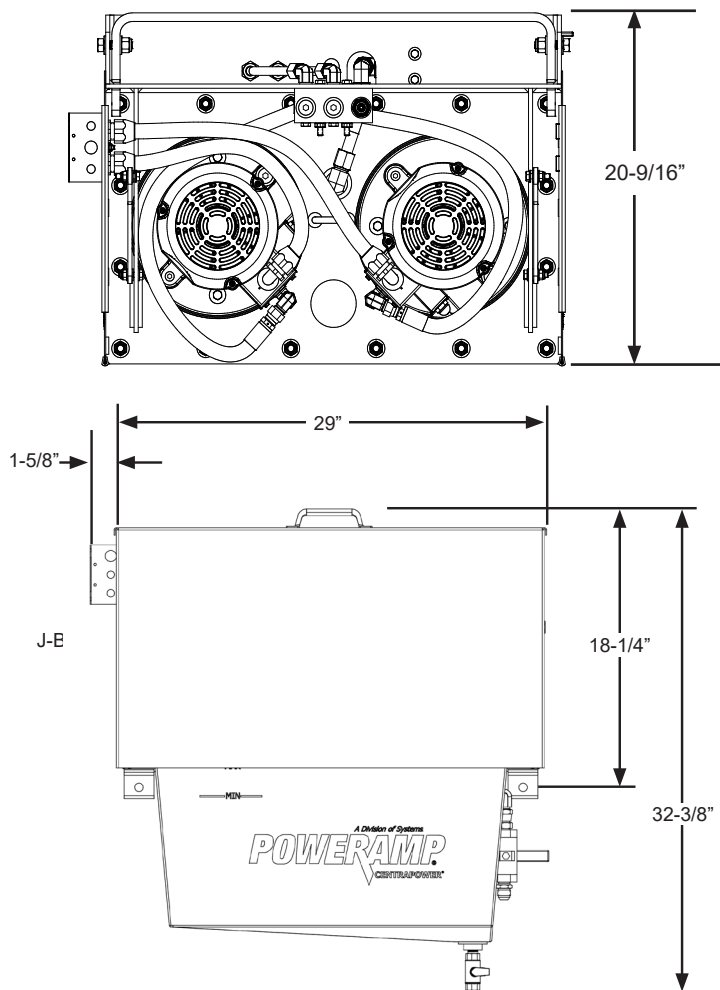

### Standard Features

|  |  |
|--|--|
| Centralized hydraulic pumping station for multiple loading dock levelers | Indicator light alerts if a motor error occurs |
| Energy savings with six or more hydraulic dock levelers                  | Isolation valve for maintenance work           |
| Equipped with backup pump and motor                                      | 18"H x 24"W x 12"D station                     |
| 12-gallon translucent reservoir  | 20"H x 16"W x 8"D motor starter box            |
| Totally enclosed fan-cooled motor  | Designed and manufactured in the USA           |

### General Description

The Poweramp CentraPower pumping station is a single source hydraulic system designed to operate as many as 12 dock levelers, or 10 dock leveler and restraint combinations.

## Construction

The CentraPower enclosure is made of formed steel to support the weight of the unit. The plastic reservoir with gasket ensures a tight seal. The reservoir is transparent for ease of inspection of the fluid level and condition.

Fluid reaches each hydraulic dock leveler through conventional hydraulic lines. In new construction, fluid lines are housed in PVC pipes embedded in concrete. Other methods of piping, such as overhead systems, are dictated by existing conditions.

## Hydraulics

The pumping station is comprised of two 1 1/2 HP 208 or 460V, 3-phase TEFC electric motors; two hydraulic pumps having a combined capacity of 4 gallons a minute and a reservoir having a 12 gallon capacity. The system is designed to operate normally with only one of the pumps and motors.

## Operation

The operation of CentraPower is seamless. The unit automatically starts when the push button is pressed at each dock position. Each CentraPower station utilizes two pumps and motors that can run simultaneously or individually depending on the hydraulic requirement at each dock position. This dual pump and motor system also provides redundancy in the operation to prevent downtime should a pump or motor issue arise. A selector switch at each CentraPower station allows the operator to select running one pump and motor set or both sets together.

## Electrical

CentraPower's motors can be powered by 3 phase 220, 460, or 575 volts. Individual dock levelers have a control box containing a push button that requires 115V wiring.

## Installation

The CentraPower pumping station is to be hung on a pre-mounted bracket to the wall at a standard height of 6 feet off the ground. Hose runs and connections need to be made at dock leveler position. The unit must be installed by qualified personnel only. See owner's/user's manual for more details.

## Order Specifications

### Required Information

|                 |  |
|-----------------|--|
| CUSTOMER        |  |
| JOB             |  |
| LOCATION        |  |
| NUMBER OF UNITS |  |
| MODEL           |  |
| SIZE            |  |
| REPRESENTED BY  |  |
| SALES REP       |  |

### Certified for Construction

|                 |  |
|-----------------|--|
| BY              |  |
| DATE            |  |
| COMPANY         |  |
| CITY & STATE    |  |
| VOLTAGE / PHASE |  |
| DRAWING #       |  |